

PARK-VUE

PATIO DOORS

SWING SCREEN SYSTEM AVAILABLE FOR YOUR SINGLE OR DOUBLE DOOR

- HEAVY DUTY EXTRUDED ALUMINUM IN A VARIETY OF STANDARD COLORS
- REVERSIBLE FOR RIGHT OR LEFT HAND OPERATION
- EASILY ATTACHED TO INSTALLED DOOR UNIT
- WIDE VARIETY OF STANDARD COLORS (SEE PARK-VUE CLAD COLOR SAMPLE CHART)
- CUSTOM COLORS



AVAILABLE FOR EVERY OPERATIVE PANEL DESIGN

TWO PANEL TRUE FRENCH UNIT

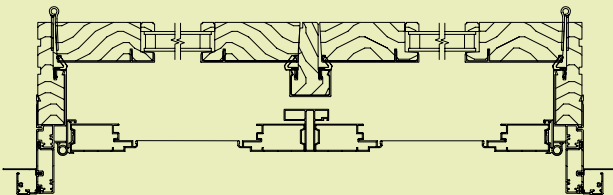

ONE PANEL UNIT

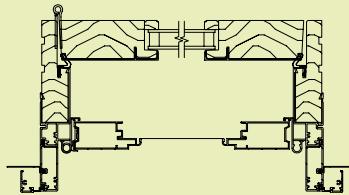

TWO PANEL MULL HINGE (SHOWN) OR JAMB HINGE UNIT

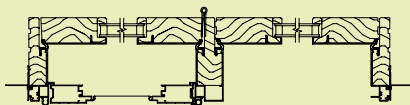

THREE PANEL MULL (SHOWN) OR JAMB HINGE UNIT

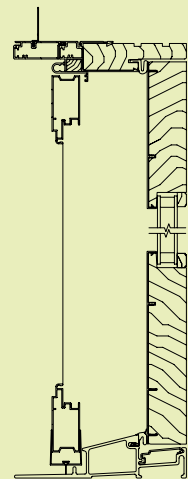
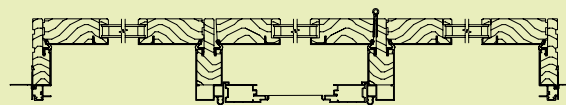

HEAD/SILL SECTION

**CONTACT YOUR DEALER
FOR PRICING**

TO LOCATE A DEALER NEAR YOU VISIT www.park-vue.com
OR CALL 715-536-8112